



City of Decatur, Illinois
Department of Public Works

#1 Gary K. Anderson Plaza
Decatur, IL 62523
Phone: (217) 424-2747
Fax: (217) 424-2799

APPLICATION FOR TEMPORARY
STREET / LANE CLOSURE

Permit - Type or Use Ink

Must be completed as directed by City of Decatur Public Works Department

APPLICANT'S NAME / ADDRESS:

DATE: \_\_\_\_\_

PHONE NUMBER: ( )

FAX NUMBER: ( )

EMAIL ADDRESS: ben.gomez@williamcharles.com

CONTACT PERSON:

LICENSE NUMBER:

PURPOSE FOR CLOSURE:

STREET(S) INVOLVED (LIST STREET NAME(S), ADDRESS(ES), BLOCK(S), ETC.):

DURATION:

FROM (DATE) -----

AT (TIME) -----

TO (DATE) -----

AT (TIME) -----

FUNCTIONAL CLASSIFICATION OF THE CLOSED ROAD / STREET(S):

IS THE ROAD / STREET TO BE COMPLETELY CLOSED? [ ] YES [ ] NO

WILL DETOUR ROUTE BE REQUIRED: YES NO

IF YES, DETOUR ROUTE WILL BE AS FOLLOWS (OR ATTACHED SEPARATE SHEET(S)): \_\_\_\_\_

THE CLOSURE OF STREETS CLASSIFIED IN THE DECATUR ROADWAY SYSTEM PLAN AS SECONDARY COLLECTORS OR GREATER WILL REQUIRE A MARKED DETOUR ROUTE UNLESS WAIVED BY THE TRAFFIC ENGINEER.

\*\*\*\*\*

**FOLLOWING THE APPROVAL OF THIS APPLICATION, THE ENGINEERING DIVISION WILL EMAIL NOTIFICATION TO THE MEDIA AND CITY OFFICES AND WILL EMIAL APPROVED PERMIT BACK TO CONTRACTOR**

\*\*\*\*\*

APPROVED BY: \_\_\_\_\_ DATE: \_\_\_\_\_
Department of Public Works

To be filled in by Public Works

DONE BY: \_\_\_\_\_

DATE: \_\_\_\_\_ TIME: \_\_\_\_\_

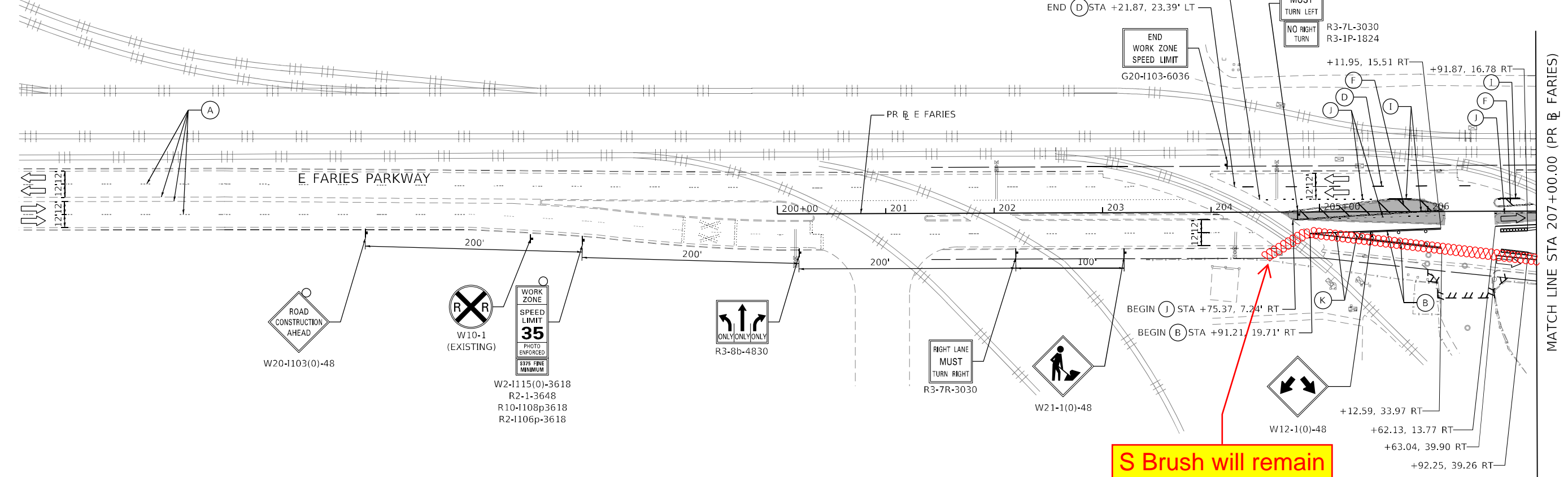
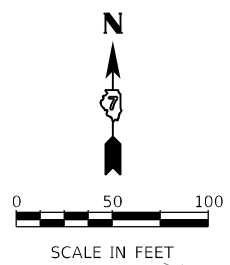

S Brush will remain closed down as is. Right turn lane shown here will not be open.

LEGEND:			
	WORK ZONE		ARROW BOARD
	TEMPORARY CONCRETE BARRIER		TEMPORARY PAVEMENT
	TEMPORARY IMPACT ATTENUATOR		WORK COMPLETED IN PREVIOUS STAGE
	TEMPORARY SOIL RETENTION SYSTEM OR BRACED EXCAVATION	(A)	EXISTING PAVEMENT MARKING
	DIRECTION OF TRAFFIC FLOW	(B)	TEMPORARY PAVEMENT MARKING - LINE 4" TYPE III TAPE (SOLID WHITE)
	TYPE III BARRICADE	(C)	TEMPORARY PAVEMENT MARKING - LINE 4" TYPE III TAPE (SOLID YELLOW)
	TYPE II BARRICADE OR DRUMS WITH STEADY BURN MONODIRECTIONAL LIGHT AT 25' SPACING	(D)	TEMPORARY PAVEMENT MARKING - LINE 6" TYPE III TAPE (10' DASH 30' SKIP, WHITE)
	SIGN	(E)	TEMPORARY PAVEMENT MARKING - LINE 6" TYPE III TAPE (SOLID, WHITE)
(F)	TEMPORARY PAVEMENT MARKING - LINE 12" TYPE III TAPE (SOLID YELLOW)	(G)	TEMPORARY PAVEMENT MARKING - LINE 24" TYPE III TAPE (SOLID WHITE)
(H)	TEMPORARY PAVEMENT MARKING - LETTERS AND SYMBOLS - TYPE III TAPE	(I)	TEMPORARY PAVEMENT MARKING - LINE 4" TYPE III TAPE (SOLID DOUBLE YELLOW)
(J)	TEMPORARY PAVEMENT MARKING - LINE 6" TYPE III TAPE (2' DASH 6' SKIP, WHITE)	(K)	TEMPORARY PAVEMENT MARKING - LINE 12" TYPE III TAPE (SOLID WHITE)

MODEL: Default; FILE NAME: p:\lucocomp\paw.bentley.com\AECOM\_051\A\Documents\60603202-Brush\_College\006-CAD\_GIS\010\_CAD\013\_SHEETS\10\_L4\AECOM\Construction\_Stage\60603202\_SHT\_Stage\010.dgn



USER NAME	maw/hinneyk	DESIGNED -	MAL	REVISED -	
DRAWN -	MAL	CHECKED -	WBS	REVISED -	
PLOT SCALE	100,000.1' / in.	DATE	10/22/2021	REVISED -	
PLOT DATE	2021-10-29				

**STATE OF ILLINOIS  
DEPARTMENT OF TRANSPORTATION**

<b>SUGGESTED STAGES OF CONSTRUCTION AND TRAFFIC CONTROL PLAN FARIES PARKWAY - PRE-STAGE B</b>		
SCALE: 1"=50'	SHEET 1 OF 3 SHEETS	STA. 200+00.00 TO STA. 207+000.00

F.A.U. RTE.	SECTION	COUNTY	TOTAL SHEETS	SHEET NO.
7448	09-00933-01-BR	MACON	1019	237
CONTRACT NO. 95893				
ILLINOIS FED. AID PROJECT				

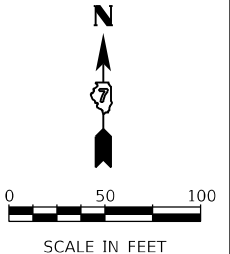

**S Brush will remain closed down as is. Right turn lane shown here will not be open.**

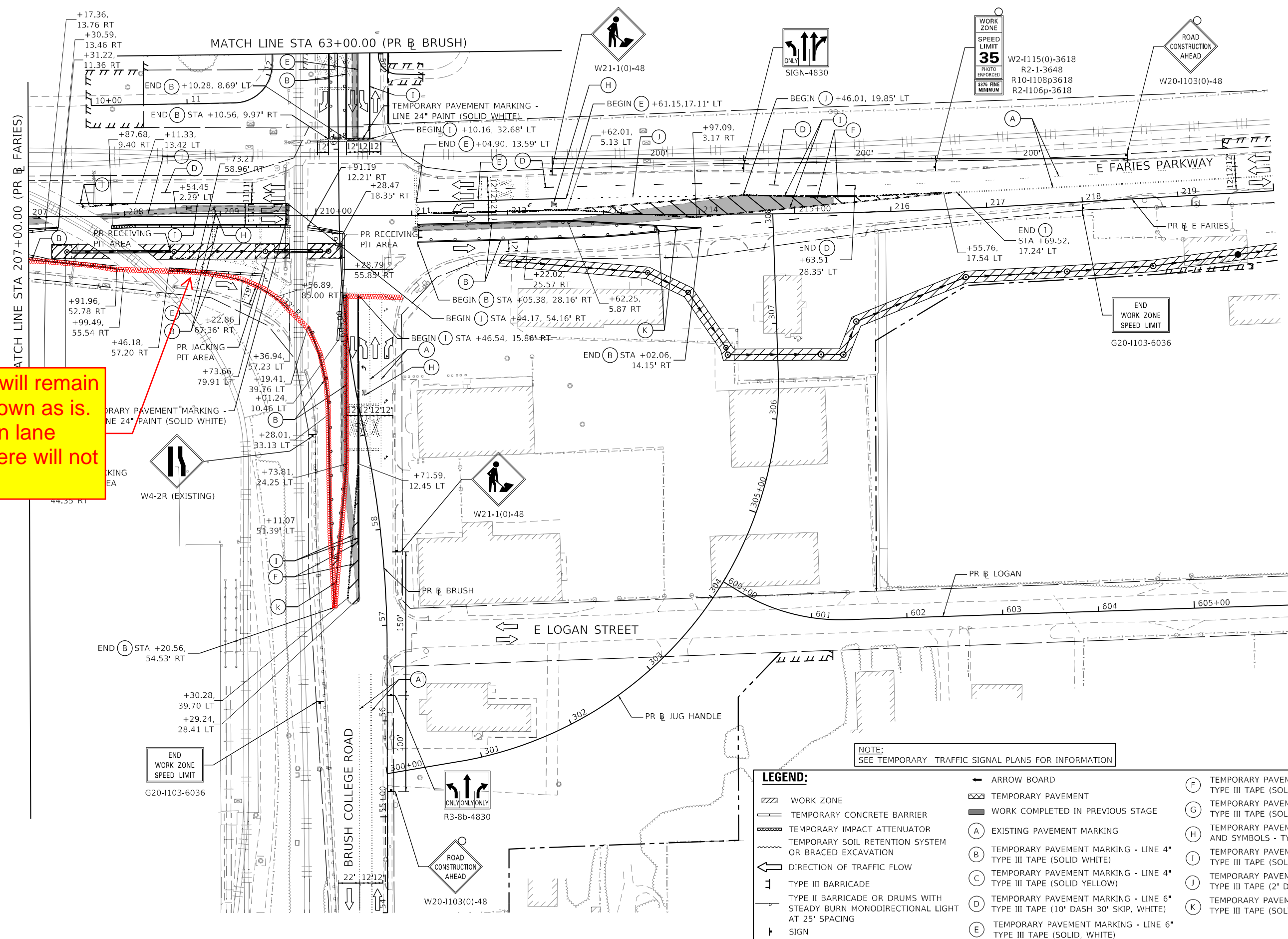

**LEGEND:**

WORK ZONE	ARROW BOARD	TEMPORARY PAVEMENT MARKING - LINE 12" TYPE III TAPE (SOLID YELLOW)
TEMPORARY CONCRETE BARRIER	TEMPORARY PAVEMENT	TEMPORARY PAVEMENT MARKING - LINE 24" TYPE III TAPE (SOLID WHITE)
TEMPORARY IMPACT ATTENUATOR	WORK COMPLETED IN PREVIOUS STAGE	TEMPORARY PAVEMENT MARKING - LETTERS AND SYMBOLS - TYPE III TAPE
TEMPORARY SOIL RETENTION SYSTEM OR BRACED EXCAVATION	EXISTING PAVEMENT MARKING	TEMPORARY PAVEMENT MARKING - LINE 4" TYPE III TAPE (SOLID DOUBLE YELLOW)
DIRECTION OF TRAFFIC FLOW	TEMPORARY PAVEMENT MARKING - LINE 4" TYPE III TAPE (SOLID WHITE)	TEMPORARY PAVEMENT MARKING - LINE 6" TYPE III TAPE (2' DASH 6' SKIP, WHITE)
TYPE III BARRICADE	TEMPORARY PAVEMENT MARKING - LINE 4" TYPE III TAPE (SOLID YELLOW)	TEMPORARY PAVEMENT MARKING - LINE 12" TYPE III TAPE (SOLID WHITE)
TYPE II BARRICADE OR DRUMS WITH STEADY BURN MONODIRECTIONAL LIGHT AT 25' SPACING	TEMPORARY PAVEMENT MARKING - LINE 6" TYPE III TAPE (10' DASH 30' SKIP, WHITE)	
SIGN	TEMPORARY PAVEMENT MARKING - LINE 6" TYPE III TAPE (SOLID, WHITE)	

NOTE:  
SEE TEMPORARY TRAFFIC SIGNAL PLANS FOR INFORMATION

MODEL: Default; FILE NAME: p:\lucocomp\pww\hennly.com\AECOM\_DSI\MA\Documents\60603202-Brush\_College\006-CAD\_GIS\10\_CAD\GIS\_SHEETS\10\_L\_AECOM\Construction\_Stationing\60603202\_SHT\_Stationing\_06\_MU.dwg



USER NAME	mawhinneyk	DESIGNED -	MAL	REVISED -	
DRAWN -	MAL	CHECKED -	WBS	REVISIION -	
PLOT SCALE	100,0001' / in.	DATE	10/22/2021	REVISIION -	
PLOT DATE	2021-10-29				

**STATE OF ILLINOIS  
DEPARTMENT OF TRANSPORTATION**

**SUGGESTED STAGES OF CONSTRUCTION AND TRAFFIC CONTROL PLAN  
BRUSH COLLEGE ROAD - PRE-STAGE B**

SCALE: 1"=50'    SHEET 2 OF 3 SHEETS    STA. 207+00.00 TO STA. 220+00.00

F.A.U. RTE.	SECTION	COUNTY	TOTAL SHEETS	SHEET NO.
7448	09-00933-01-BR	MACON	1019	238
CONTRACT NO. 95893				
ILLINOIS / FED. AID PROJECT				

