

STANDARD DESIGN FRAME AND GRATE, TYPE 11 & 11V

GRATE TYPE 11

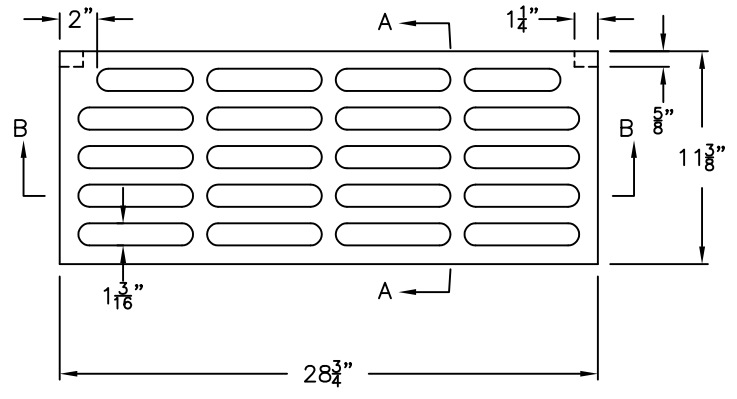

GRATE TYPE 11V

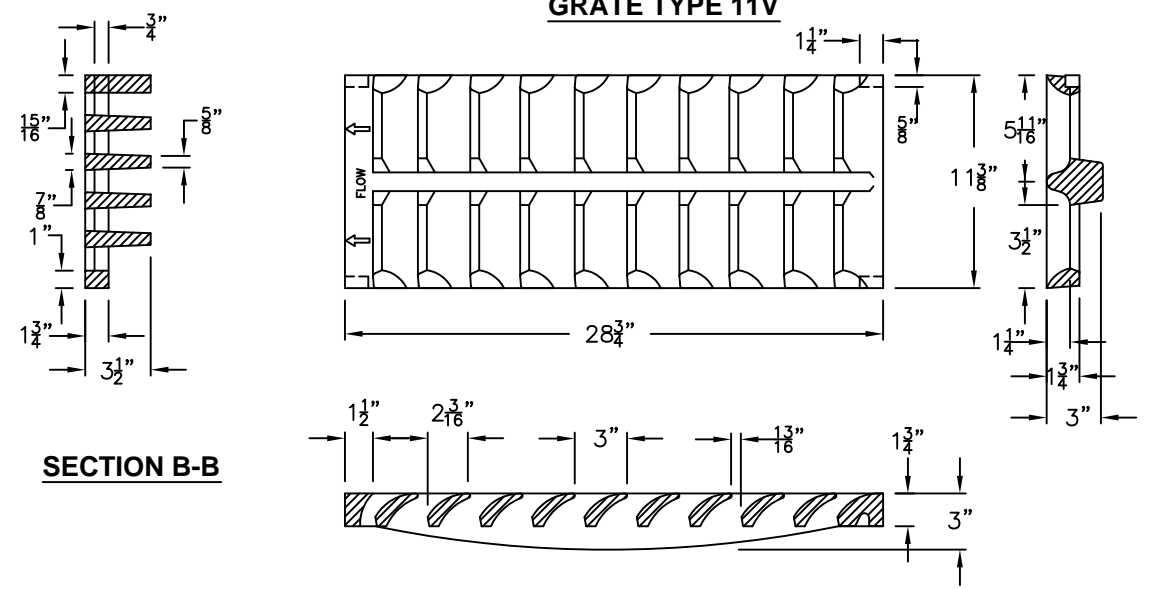

SECTION B-B

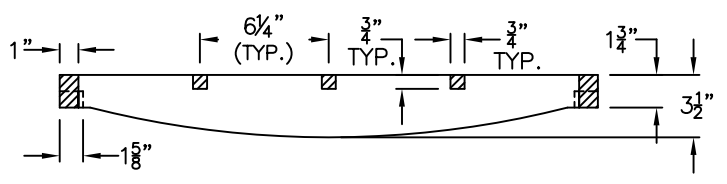

SECTION A-A

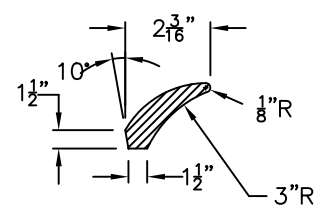

VAIN DETAIL

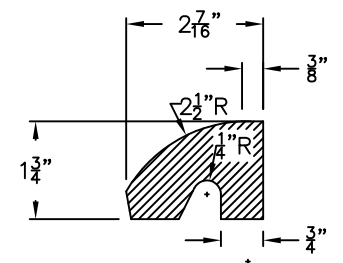

FRONT VAIN DETAIL

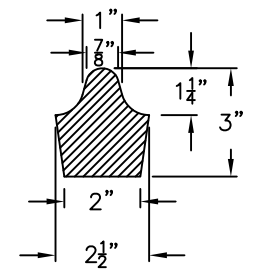

MIDDLE RIB DETAIL

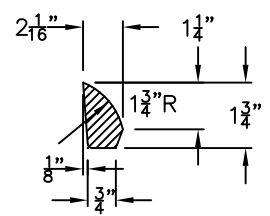

SIDE RIB DETAIL

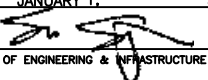
CITY OF DECATUR, ILLINOIS DEPARTMENT OF ENGINEERING INFRASTRUCTURE	ISSUED: 7-3-78	
	REVISIONS	
ADOPTED JANUARY 1, 2003  DIRECTOR OF ENGINEERING & INFRASTRUCTURE	BY	DATE
	F.W.T.	12/15/81
	SHOE	9/15/89
	JMM	5/01/02